

AP MORGAN

Essex Street, Birmingham, West
£1,600 per month

Features:

- Modern upper floor apartment
- Balcony
- City Centre location
- Two double bedrooms with en-suites
- Spacious lounge/diner
- Private balcony
- Stylish fitted kitchen
- 24hr concierge service
- EPC- C



Description:

*** VIEWING EVENT ON SATURDAY 9TH MARCH ***

Available now, this spacious and well-presented upper floor apartment has accommodation comprising: Entrance hallway with two large storage cupboards and a W.C, spacious and open plan lounge/dining area with UPVC door leading onto the balcony, fitted kitchen with integrated appliances as well as space for freestanding ones, private balcony with views of the city centre and finally two double bedrooms each having their own en-suites with the latter also having a walk-in wardrobe. The apartment also benefits from a 24hr concierge service.



Located in the heart of Birmingham City Centre, this is a particularly popular area for young couples or professionals with a vast array of local amenities to choose from including the Bull Ring shopping centre and Hippodrome Theatre as well as very good transport links via car with the closest motorway access being Junction Six on the M6 or via public transport with regular bus and train services travelling in and out the city.



Details:

Lounge/Diner 18'3" x 16'8" (5.56m x 5.08m)

Kitchen 10'9" x 8'3" (3.28m x 2.51m)

Bedroom One 12'11" x 12'2" (3.94m x 3.7m)

En-suite One 7'2" x 6'6" (2.18m x 1.98m)

Bedroom Two 11'2" x 9'11" (3.4m x 3.02m)

En-suite Two 7'2" x 5'6" (2.18m x 1.68m)

Walk-In Wardrobe 7'9" x 5'7" (2.36m x 1.7m)

W.C 5' x 3'4" (1.52m x 1.02m)

Entrance Hall



EPC Rating: C

How can we help you?

Need a mortgage?

We recommend Wiser Mortgage Advice. They will search the market for you to ensure you get the right lender and mortgage deal. They typically achieve mortgage offers much more quickly than if you were dealing with lenders directly. The initial appointment is free and without obligation. Call us on 01384 319 400, or visit their website for more information: www.wisermortgageadvice.co.uk

Property to sell?

If you need to sell a property in order to buy, you ideally need to be on the market at least (and preferably Sold STC) before viewing, otherwise you may lose out to other buyers when the right property comes along. In these circumstances we can get your property 'live' quickly. Just book a free valuation and we will visit your property and discuss your needs.

Need a solicitor?

A good solicitor can save you literally weeks of time in the buying/selling process, reducing the stress levels of all involved. We will instruct a reputable firm that is competitive on cost and very reliable. Just ask for a quote.

Need a removal company and storage?

A professional removal company takes the stress out of moving, knowing that your belongings are safe and insured far outweighs any small savings by trying to do it yourself or using a man-and-a-van service. We work closely with and recommend Cube Removals as the leading local firm. For peace of mind and a reliable service call them on 0800 193 0000 or visit their website, cuberemovals.co.uk, to arrange a survey.

GROUND FLOOR
1139 sq.ft. (105.8 sq.m.) approx.

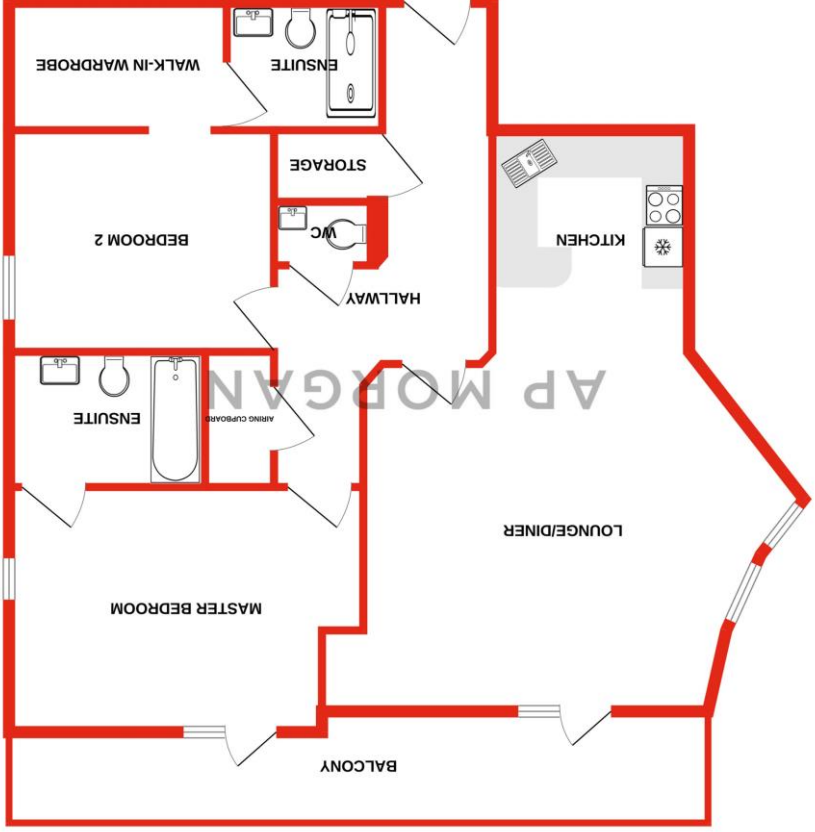

What every attempt has been made to ensure the accuracy of the floorplan contained here. Measurements of doors, windows, rooms and other items are approximately taken to the best of our knowledge. The plan is for illustrative purposes only and should be used as such by any prospective purchaser. The services, systems and appliances shown have not been tested and no guarantee is made as to their operability or efficiency can be given. Made with Metropix ©2024

No statement in these details is to be relied upon as representation of fact, and purchasers should satisfy themselves by inspection or otherwise as to the accuracy of the statements contained within. These details do not constitute any part of any offer or contract. AP Morgan and their employees and agents do not have any authority to give any warranty or representation whatsoever in respect of this property. These details and all statements herein are provided without any responsibility on the part of AP Morgan or the vendors. Equipment: AP Morgan has not tested the equipment or central heating system mentioned in these particulars and the purchasers are advised to satisfy themselves as to the working order and condition. Measurements: Great care is taken when measuring, but measurements should not be relied upon for ordering carpets, equipment, etc. The Laws of Copyright protect this material. AP Morgan is the Owner of the copyright. This property sheet forms part of our database and is protected by the database right and copyright laws. No unauthorised copying or distribution without permission.